

Sectors of Edge-Insulating Angle Rings

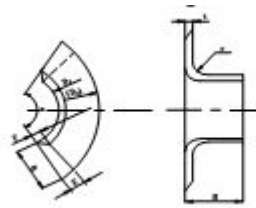

Suitable for protecting edges of coils. The chamfer R matches very well with the edges of coil conductor.

Dimension range and Tolerance

W	H	r	t		
			1.0	1.5	2.0
±2	±2	±2	+0.2	+0.4	+0.4

Available dimension of products:

φ D	W ≤	r	H
84	55	10	175
112	107	10	100
180	89	3	110
258	140	20	148
304	60	20	60
380	109	5	120
458	60	5	60
556	98	10	150
658	110	3	150
770	60	3	60
856	60	3	60
956	60	3	60
1054	60	3	60
1159	60	3	60
1270	60	3	60
1380	60	3	60
1488	60	3	60
1564	60	3	60
1678	60	3	60
1804	60	3	60
1900	60	3	60
2100	60	3	60
2176	60	3	60
2202	60	3	60
2332	60	3	60
2465	60	3	60