

Snout and Inclined Snout Channel

Molded by hands.

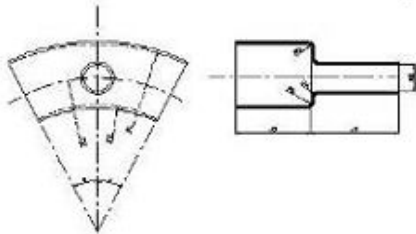

直筒引线角环槽
Snout Channel

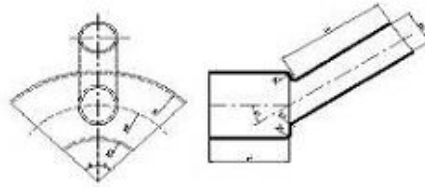

斜筒引线角环槽
Inclined Snout Channel

Tolerances

Snout Channels

尺寸/Dimensions	H	H1	d	R1	R2	R3	R4	R5、R6	a1	ζ
偏差/Tolerance	0 -3	0 -3	+2 -1	0 -2.5	0 -0.5	0 -2.5	+10 0	+4 0	± 1°	+1.5 0

Inclined Snout Channels

尺寸 Dimensions	H	H1	d	R1	R2、R3	R4	R5、R6	a1	a2	ζ
偏差 Tolerance	0 -3	0 -3	+2 -1	0 -2.5	0 -2.5	+10 0	+4 0	± 1°	± 5°	+1.5 0